

**SPRING
TERMINAL BLOCK**

TYPE STB851



SPECIFICATIONS

WIRE ENTRANCE:Vertical to PCB	WIRE PROTECTOR:Steel, Ni Plated
CENTER SPACING: 5.00mm / 0.197 in	TERMINAL:Brass, Tin Plated
WIRE RANGE:14--22AWG	TEMPERATURE:
ELECTRICAL RATING:300V, 10A	OPERATING:.....-40°C to +105°C
BREAKDOWN VOLTAGE:4,000V	-40°C to +221°C
MOLDING:Polyamide, UL94, V-0	MAX.SOLDERING:.....260°C , +500° F
Self Extinguishing	for 5 seconds

MECHANICAL DIMENSIONS

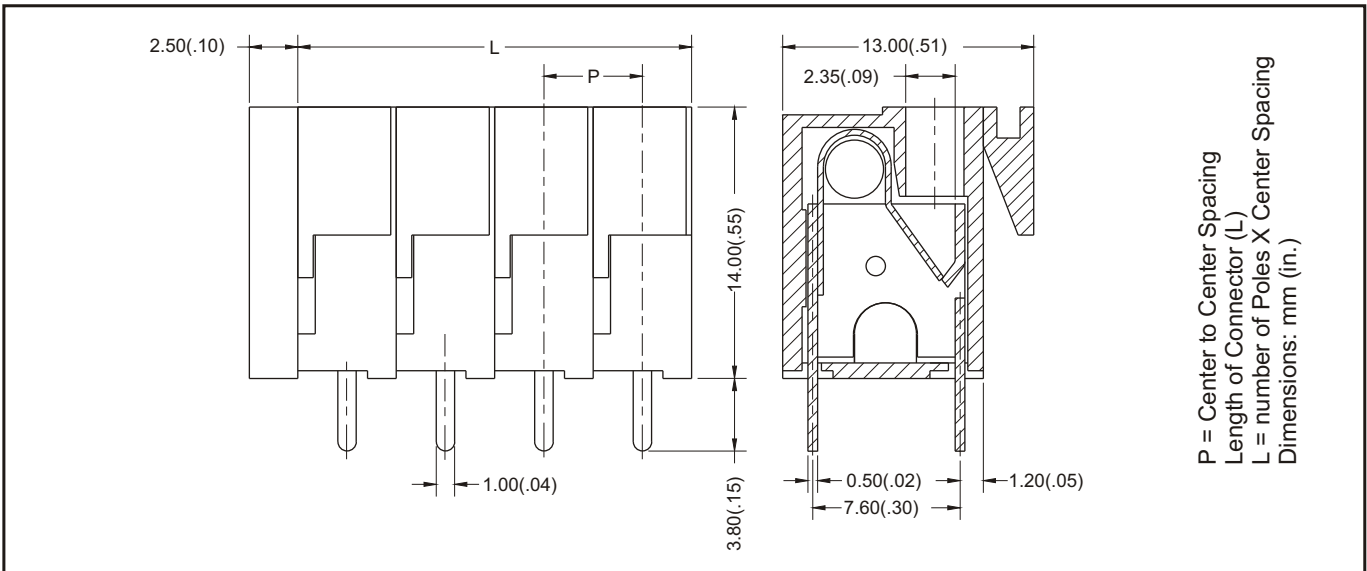

ORDERING INFORMATION

STB851 — — — — —

Style 00 to 99	Spacing 1=5.00mm 2=5.08mm	Poles 02 to 24	Color 0=Light Grey 1=Black 2=Blue 3=Green 4=Dark Grey	Options*
--------------------------	--	--------------------------	---	-----------------

Options*: M1~M9, For Customer Modification (Please provide sketch).
If more than one option is required, please separate each option with a dash (-).